

CLASS A OFFICE WITH SCIF AVAILABLE FOR LEASE

1795 Jet Wing Dr | Colorado Springs, CO 80916



Ideal For Aerospace & Defense Uses

PROPERTY HIGHLIGHTS

- 19,092 SF Total Office Space including 6,410 SF Existing SCIF Area | Enterprise Zone
- Class A Office Environment Secure Building Access | Zoned MX-N AO
- Partially Furnished Space | Dedicated Exterior Entrance
- Exterior Patio with Beautiful West-Facing Views
- Minutes from Peterson SFB, Schriever SFB & Colorado Springs Airport
- Surrounded by numerous Defense contractors including SERCO, Northrop Grumman, Booz Allen, Boeing, Lockheed Martin & L3 Harris
- \$18.50 PSF base lease rate plus \$9.27 PSF NNN expenses



SOCO Commercial Real Estate, LLC
17 South Wahsatch Avenue
Colorado Springs, CO 80903
www.sococre.com

RUSSELL STROUD, CCIM | Principal
rstroud@sococre.com | 719.238.8695

MARY FRANCES COWAN, CCIM | Principal
mcowan@sococre.com | 719.337.1500

Visit the Property Website to View Additional Photos

<https://soco.aryeo.com/sites/1795-jet-wing-dr-colorado-springs-co-80916-24881780/branded>



PROPERTY SPECIFICATIONS

AVAILABLE SPACE	19,092 SF
BASE LEASE RATE	\$18.50 PSF, NNN
NNN EXPENSES	\$9.27 PSF (2025 Actuals)
ZONING	MX-N AO



RUSSELL STROUD, CCIM | Principal
rstroud@sococre.com | 719.238.8695

MARY FRANCES COWAN, CCIM | Principal
mcowan@sococre.com | 719.337.1500

THE INFORMATION CONTAINED HEREIN WAS OBTAINED FROM SOURCES BELIEVED TO BE RELIABLE, HOWEVER, SOCO COMMERCIAL REAL ESTATE, LLC MAKES NO GUARANTEES, WARRANTIES, OR REPRESENTATIONS AS TO THE COMPLETENESS OR ACCURACY THEREOF. THE PRESENTATION OF THIS PROPERTY IS SUBMITTED SUBJECT TO ERRORS, CHANGES OF PRICE OR CONDITIONS PRIOR TO SALE OR LEASE, OR WITHDRAWAL WITHOUT NOTICE

First Floor

±19,092 SF Total Office Space including ±6,410 SF Existing SCIF Area

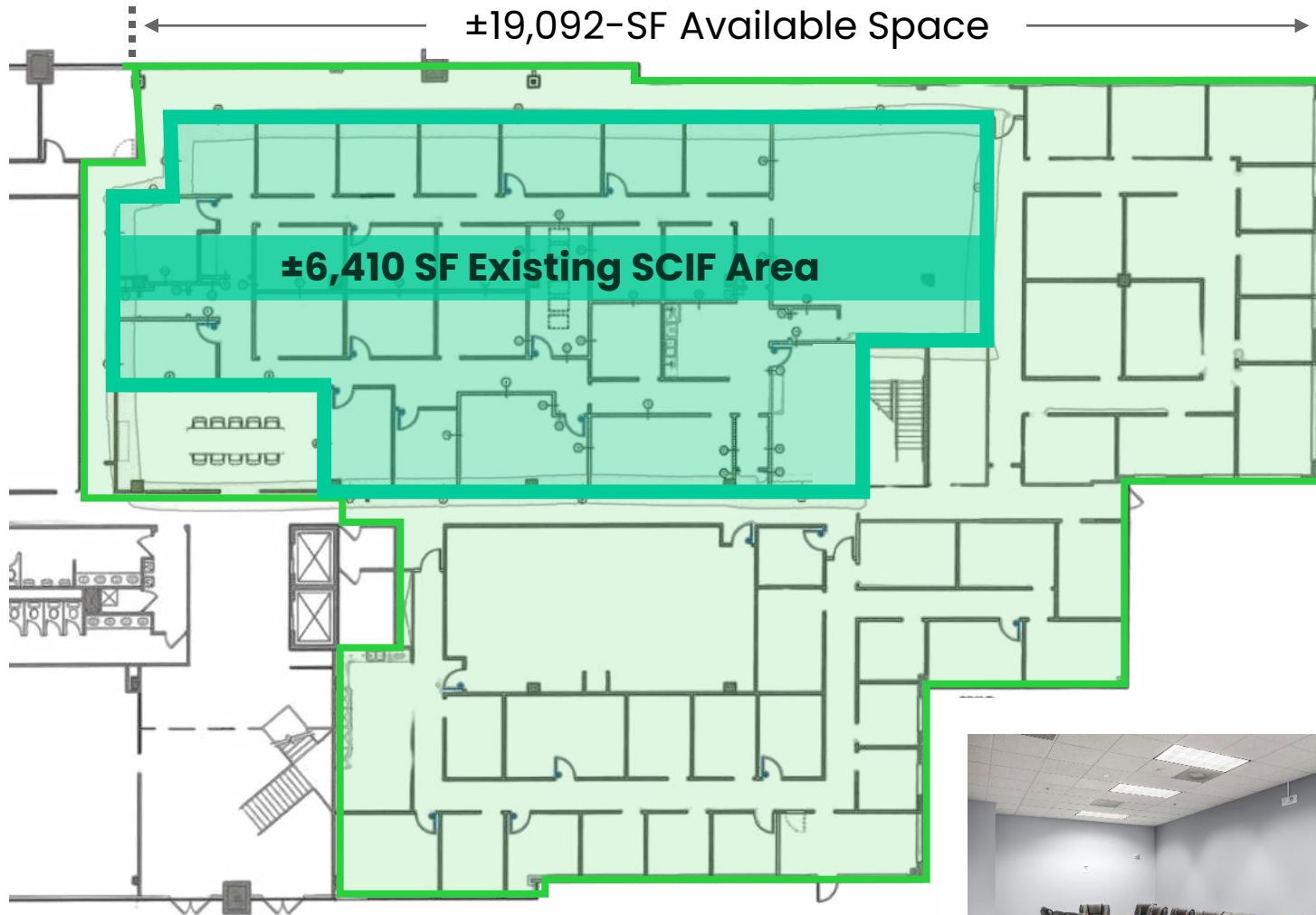

FEATURES

- Existing SCIF area for secure operations
- Dedicated entrance for controlled access
- Efficient layout supporting collaborative and classified work environments
- Move-in readiness with partial furnishings included



Benefit from Close Proximity to Peterson SFB, Schriever SFB & Colorado Springs Airport

