

Coutura Center at Furniture Row

6380 Corporate Centre Circle | Colorado Springs, CO 80919

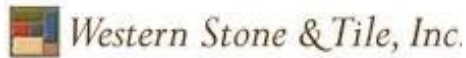

Join these tenants:



- 370-3,827 SF available
- Building & monument signage available
- Concierge service
- High-end interior & exterior finishes
- Access to hiking & biking trail
- Shared rooftop patio & entertainment space
- Shared conference room
- Visible from I-25 with 106,937 vehicles per day
- Shadow-anchored by Furniture Row



SOCO Commercial Real Estate, LLC
17 South Wahsatch Avenue
Colorado Springs, CO 80903
www.sococre.com

RUSSELL STROUD, CCIM | 719.238.8695
Principal | rstroud@sococre.com

MARY FRANCES COWAN, CCIM | 719.337.1500
Principal | mcowan@sococre.com

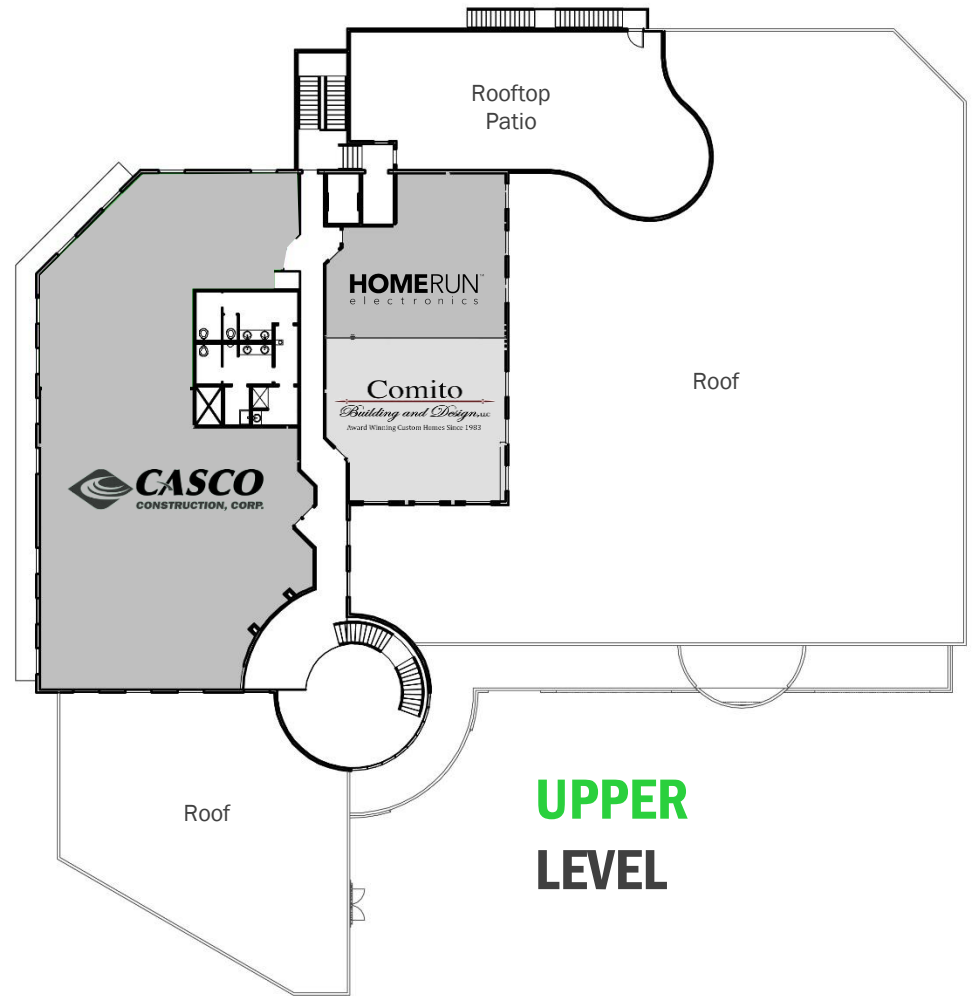

THE INFORMATION CONTAINED HEREIN WAS OBTAINED FROM SOURCES BELIEVED TO BE RELIABLE, HOWEVER, SOCO COMMERCIAL REAL ESTATE, LLC MAKES NO GUARANTEES, WARRANTIES, OR REPRESENTATIONS AS TO THE COMPLETENESS OR ACCURACY THEREOF. THE PRESENTATION OF THIS PROPERTY IS SUBMITTED SUBJECT TO ERRORS, CHANGES OF PRICE OR CONDITIONS PRIOR TO SALE OR LEASE, OR WITHDRAWAL WITHOUT NOTICE

COUTURA CENTER AT FURNITURE ROW

Santa Fe Trail
16.9 miles of
hiking/biking
trails

Shared Rooftop
& Entertainment
Space



UNIVERSITY VILLAGE COLORADO

COSTCO WHOLESALE **LOWE'S** **TRADER JOE'S**

KOHL'S **pure barre** **COWBOY STAR RESTAURANT & BREWERY** **christy sports**

VEDA SALON & SPA **crumbl cookies** **DULUTH TRADING** **Starbucks**

LYCALS BARBERSHOP & SALON **NAVY FEDERAL Credit Union** **Panera BREAD** **smash burger** **BJ's**

petco **BONEFISH** **CHIPOTLE**

noodles company **GRILL** **Keva** **Juice** **UBROD EGG**

HACIENDA COLORADO **Tokyo JOE'S**

